

# Building 1

## 3 floors I 17 apartments

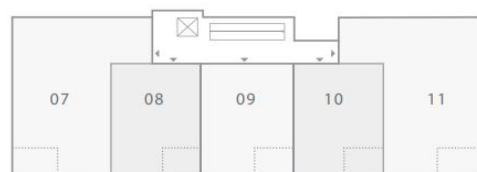

apartment	number of bedrooms	total area (M <sup>2</sup> )	terrace (M <sup>2</sup> )	green terrace (M <sup>2</sup> )	extra rooftop (M <sup>2</sup> )	price (EUR)	full payment price (EUR)
<b>(-1) Commercial premises Suterren / Basement</b>							
01_01		81,93		10,71		344 000	326 800
01_02		52,37		9,73		212 000	201 400
01_03		SOLD					
01_04		SOLD					
01_05		52,19		9,73		212 000	201 400
01_06a		28,51		4,86		117 000	111 150
01_06b		50,11		7,78		207 000	196 650
<b>(0) Prizemlje / Ground floor</b>							
01_07	2	79,09	4,25			347 000	329 650
01_08	1	43,45	4,62			199 000	189 050
01_09	1	SOLD					
01_10	1	43,90	4,62			202 000	191 900
01_11	2	74,16	4,88			338 000	321 100
<b>(1) Prvi sprat / First floor</b>							
01_12	2	79,09	4,25		77,49	529 000	502 550
01_13	1	43,45	4,62		51,71	344 000	326 800
01_14	1	43,90	4,62		64,89	379 000	360 050
01_15	1	43,90	4,62		50,78	344 000	326 800
01_16	2	74,16	4,88		77,64	498 000	473 100

## Building 2

4 floors | 10 apartments

4 Commercial premises

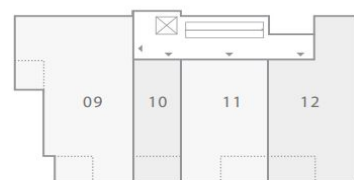
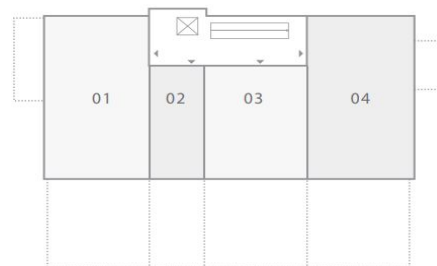

apartment	number of bedrooms	total area (M <sup>2</sup> )	terrace (M <sup>2</sup> )	green terrace (M <sup>2</sup> )	extra rooftop (M <sup>2</sup> )	price (EUR)	full payment price (EUR)
<b>(-1) Commercial premises Suterren / Basement</b>							
02_01		110,74		45,78		394 000	374 300
02_02		33,65		12,65		129 000	122 550
02_03		77,03		35,41		265 000	251 750
02_04		92,57		42,07		354 000	336 300
<b>(0) Prizemlje / Ground floor</b>							
02_05	2	84,94	14,03			373 000	354 350
02_06	Studio	SOLD					
02_07	1	53,05	5,95			255 000	242 250
02_08	2	61,44	5,95			286 000	271 700
<b>(1) Prvi sprat / First floor</b>							
02_09	2	84,67	7,90			389 000	369 550
02_10	Studio	SOLD					
02_11	1	53,05	5,95			RESERVED	
02_12	2	71,79	5,95			337 000	320 150
<b>(2) Povuceni sprat / Second floor</b>							
02_13 ROOF-TOP ACCESS	2	81,58		17,75	68,03	504 000	478 800
02_14 ROOF-TOP ACCESS	2	124,78	5,23	53,3	69,46	612 000	581 400

## Building 3

4 floors | 10 apartments

4 Commercial premises

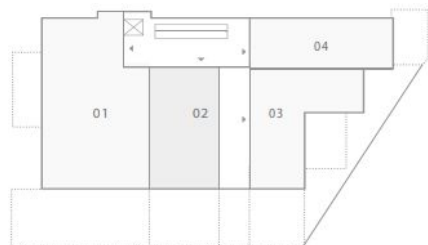

apartment	number of bedrooms	total area (M <sup>2</sup> )	terrace (M <sup>2</sup> )	green terrace (M <sup>2</sup> )	extra rooftop (M <sup>2</sup> )	price (EUR)	full payment price (EUR)
<b>(-1) Commercial premises Suterren / Basement</b>							
03_01		87,75		25,61		RESERVED	
03_02		SOLD					
03_03		35,33		13,26		129 000	122 550
03_04		33,47				149 000	141 550
<b>(0) Prizemlje / Ground floor</b>							
03_05	2	SOLD					
03_06	1	SOLD					
03_07	1	45,30	4,41			208 000	197 600
03_08	Studio	24,94	3,89			114 000	108 300
<b>(1) Prvi sprat / First floor</b>							
03_09	2	74,46	6,36			349 000	331 550
03_10	1	56,00	6,36			271 000	257 450
03_11	1	SOLD					
03_12	Studio	24,94	3,89			124 000	117 800
<b>(2) Povuceni sprat / Second floor</b>							
3_13 ROOF-TOP ACCESS	1	88,83		35,40	60,90	395 000	375 250
03_14 ROOF-TOP ACCESS	2	SOLD					

# Building 4

## 5 floors | 16 apartments

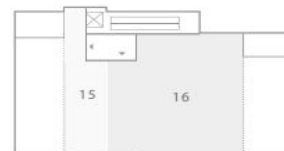
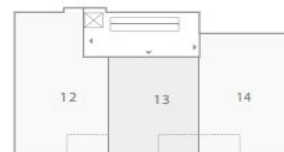
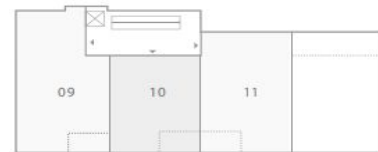
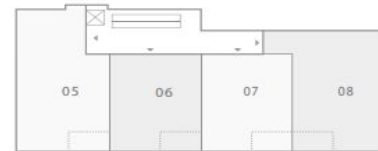
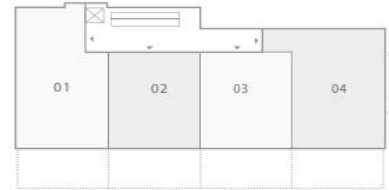

apartment	number of bedrooms	total area (M <sup>2</sup> )	terrace (M <sup>2</sup> )	green terrace (M <sup>2</sup> )	extra rooftop (M <sup>2</sup> )	price (EUR)	full payment price (EUR)
<b>(0) Prizemlje / Ground floor</b>							
04_01	2	99,77		44,85		319 000	303 050
04_02	1	56,20		14,82		223 000	211 850
04_03	1	SOLD					
04_04	1	67,64		14,82		265 000	251 750
<b>(1) Prvi sprat / First floor</b>							
04_05	2	SOLD					
04_06	1	SOLD					
04_07	1	SOLD					
04_08	1	SOLD					
<b>(2) Povuceni sprat / Second floor</b>							
04_09	2	SOLD					
04_10	1	SOLD					
04_11	2	SOLD					
<b>(3) Treci sprat / Third floor</b>							
04_12	2	SOLD					
04_13	1	SOLD					
04_14	1	SOLD					
<b>(4) Povuceni sprat / Fourth floor</b>							
04_15 ROOF-TOP ACCESS	Studio	47,37		22,90	28,30	259 000	246 050
04_16 ROOF-TOP ACCESS	2	90,68		20,09	88,32	619 000	588 050

# Building 5

## 5 floors | 22 apartments

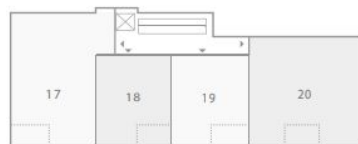
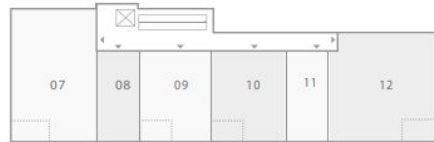
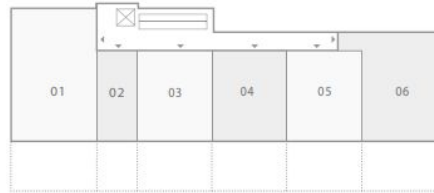

	apartment	number of bedrooms	total area (M <sup>2</sup> )	terrace (M <sup>2</sup> )	green terrace (M <sup>2</sup> )	extra rooftop (M <sup>2</sup> )	price (EUR)	full payment price (EUR)
Prizemlje / Ground floor (0)	05_01	2	93,30		26,35		339 000	322 050
	05_02	Studio	SOLD					
	05_03	1	65,26		23,66		241 000	228 950
	05_04	1	65,26		23,66		241 000	241 000
	05_05	1	65,11		23,66		239 000	227 050
	05_06	1	74,75		23,43		280 000	266 000
Prvi sprat / First floor (1)	05_07	2	68,60	4,21			317 000	301 150
	05_08	Studio	21,00				RESERVED	
	05_09	1	SOLD					
	05_10	1	SOLD					
	05_11	Studio	22,44				115 000	109 250
	05_12	2	68,17	4,43			328 000	311 600
Drugi sprat / Second floor (2)	05_13	2	SOLD					
	05_14	1	SOLD					
	05_15	1	SOLD					
	05_16a	Studio	SOLD					
	05_16b	1	80,44		41,92		298 000	283 100
Treci sprat / Third floor (3)	05_17	2	SOLD					
	05_18	1	SOLD					
	05_19	1	SOLD					
	05_20a	Studio	SOLD					
	05_20b	1	40,77	4,29			RESERVED	
Povuceni sprat / Fourth floor (4)	05_21 ROOF-TOP ACCESS	1	78,12	3,92	20,07	66,62	504 000	478 800
	05_22 ROOF-TOP ACCESS	1	119,74	6,24	74,64	54,94	548 000	520 600

# Building 6

## 5 floors | 14 apartments

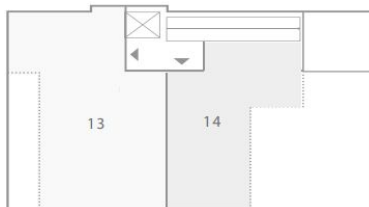
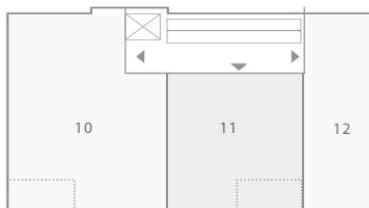
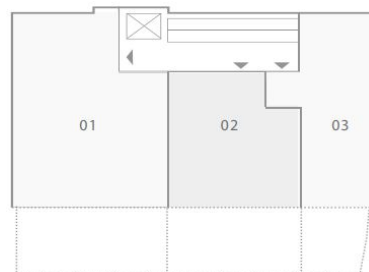

apartment	number of bedrooms	total area (M <sup>2</sup> )	terrace (M <sup>2</sup> )	green terrace (M <sup>2</sup> )	extra rooftop (M <sup>2</sup> )	price (EUR)	full payment price (EUR)
<b>(0) Prizemlje / Ground floor</b>							
06_01	2	SOLD					
06_02	1	64,39		23,43		241 000	228 950
06_03	1	SOLD					
<b>(1) Prvi sprat / First floor</b>							
06_04	2	63,05	4,43			291 000	276 450
06_05	1	41,75	4,90			214 000	203 300
06_06	2	SOLD					
<b>(2) Drugi sprat / Second floor</b>							
06_07	2	SOLD					
06_08	1	SOLD					
06_09	1	SOLD					
<b>(3) Treci sprat / Third floor</b>							
06_10	2	SOLD					
06_11	1	SOLD					
06_12	1	34,37				194 000	184 300
<b>(4) Povuceni sprat / Fourth floor</b>							
06_13	2	58,78		6,31	55,31	424 000	402 800
06_14	1	SOLD					